

Seat — Front

NOTE: LH shown, RH similar.

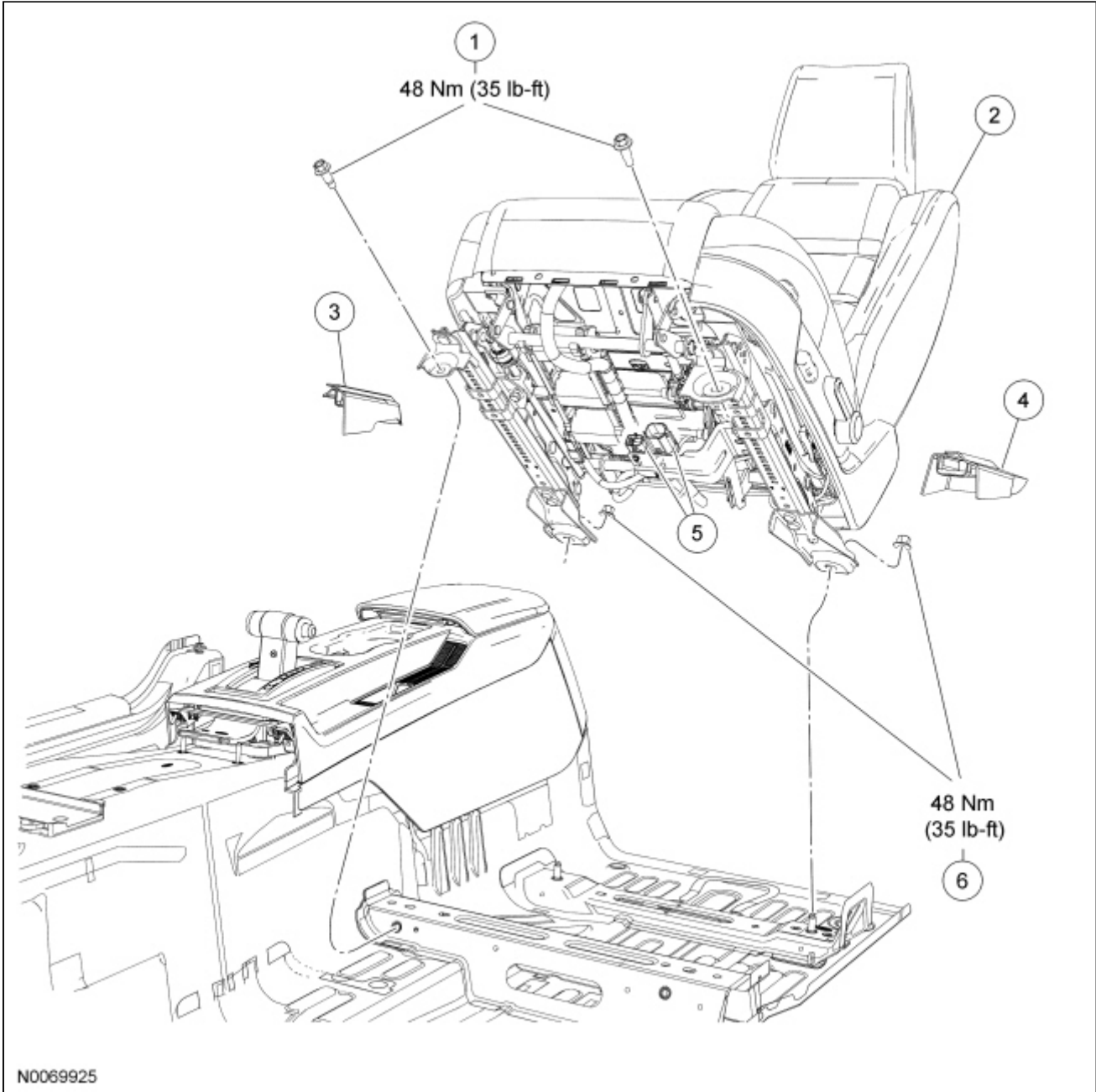

N0069925

Item	Part Number	Description
1	—	Seat track-to-floor bolts
2	—	Front seat
3	618C84	Inboard seat track nut cover
4	618C82	Outboard seat track nut cover
5	—	Seat electrical connectors (part of 14A699)
6	N807939	Seat track-to-floor nuts

Removal and Installation



WARNING: Never probe the electrical connectors on air bag, safety canopy or side air curtain modules. Failure to follow this instruction may result in the accidental deployment of these modules, which increases the risk of serious personal injury or death.

NOTE: The air bag warning indicator illuminates when the correct Restraints Control Module (RCM) fuse is removed and the ignition switch is ON.

NOTE: The Supplemental Restraint System (SRS) must be fully operational and free of faults before releasing the vehicle to the customer.

1. Position the seat to gain access to the seat track-to-floor nuts and bolts.
 2. Depower the [SRS](#). For additional information, refer to Supplemental Restraint System (SRS) Depowering and Repowering in the General Procedures portion of [Section 501-20B](#).
 3. Remove the 2 seat track nut covers.
 4. Remove the 2 seat track-to-floor nuts.
 - To install, tighten to 48 Nm (35 lb-ft).
 5. Remove the 2 seat track-to-floor bolts.
 - To install, tighten to 48 Nm (35 lb-ft).
 6. Disconnect the side air bag module and main seat harness electrical connectors and remove the seat.
 7. To install, reverse the removal procedure.
 8. Repower the [SRS](#). For additional information, refer to Supplemental Restraint System (SRS) Depowering and Repowering in the General Procedures portion of [Section 501-20B](#).
-